



Lewis Gardens, London

- Two Bedroom Apartments
- Open plan Kitchen/lounge
- Leasehold
- Modern development
- Allocated Parking
- Access to Stoke Newington & Seven Sisters stations

Offers In Excess Of £350,000

HUNTERS®
HERE TO GET *you* THERE

Lewis Gardens, London

DESCRIPTION

A well presented two bedroom apartment set on the third floor of a purpose built development with communal gardens and allocated parking. The property consists of an open plan lounge, fitted kitchen/diner, tiled bathroom, two bedrooms and off street parking. The property benefits from modern fittings and appliances and the building has a lift. Transport links include Stoke Newington Station (Overground), Stamford Hill Station (Overground), Seven Sisters Station (Victoria Line and National Rail) and a variety of Bus routes into The City & West End.



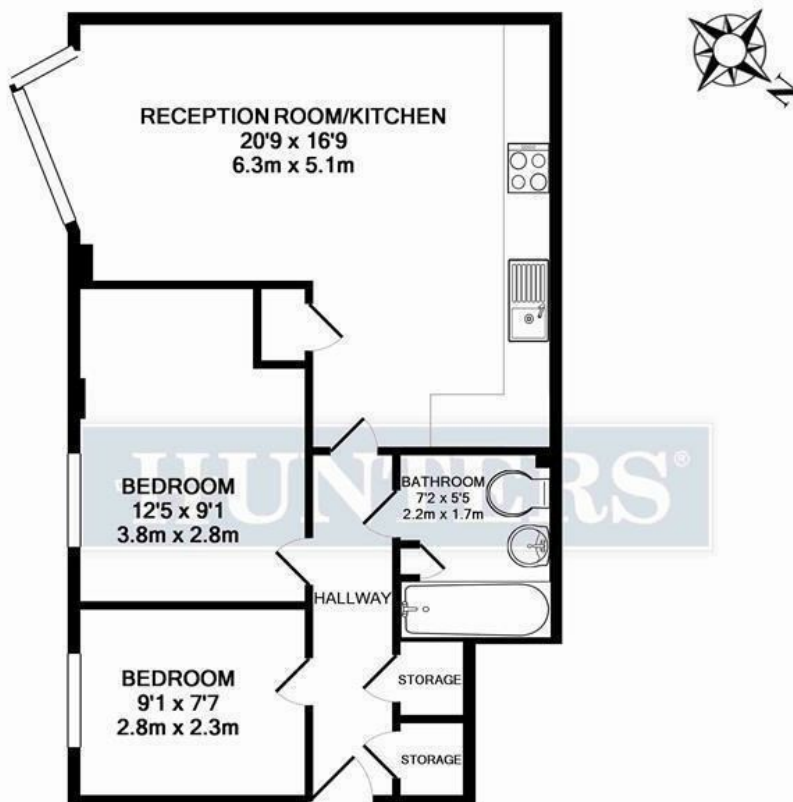

TOTAL APPROX. FLOOR AREA 549 SQ.FT. (51.0 SQ.M.)

Whilst every attempt has been made to ensure the accuracy of the floor plan contained here, measurements of doors, windows, rooms and any other items are approximate and no responsibility is taken for any error, omission, or mis-statement. This plan is for illustrative purposes only and should be used as such by any prospective purchaser. The services, systems and appliances shown have not been tested and no guarantee as to their operability or efficiency can be given
Made with Metropix ©2015

Viewing

Please contact our Hunters Stoke Newington Office on 0207 2497 499 if you wish to arrange a viewing appointment for this property or require further information.

185 - 187 Church Street, Stoke Newington, London, N16 0UL
Tel: 0207 2497 499 Email:
hunters.stokenewington@hunters.com <https://www.hunters.com>



ENERGY PERFORMANCE CERTIFICATE

The energy efficiency rating is a measure of the overall efficacy of a home. The higher the rating the more energy efficient the home is and the lower the fuel bills will be.

| Energy Efficiency Rating | | |
|---|---|-----------|
| | Current | Potential |
| Very energy efficient - lower running costs | | |
| (92 plus) A | | |
| (81-91) B | | |
| (69-80) C | | |
| (55-68) D | | |
| (39-54) E | | |
| (21-38) F | | |
| (1-20) G | | |
| Not energy efficient - higher running costs | | |
| England & Wales | EU Directive 2002/91/EC  | |

These particulars are intended to give a fair and reliable description of the property but no responsibility for any inaccuracy or error can be accepted and do not constitute an offer or contract. We have not tested any services or appliances (including central heating if fitted) referred to in these particulars and the purchasers are advised to satisfy themselves as to the working order and condition. If a property is unoccupied at any time there may be reconnection charges for any switched off/disconnected or drained services or appliances - All measurements are approximate.

THINKING OF SELLING? If you are thinking of selling your home or just curious to discover the value of your property, Hunters would be pleased to provide free, no obligation sales and marketing advice. Even if your home is outside the area covered by our local offices we can arrange a Market Appraisal through our national network of Hunters estate agents.

HUNTERS®
HERE TO GET *you* THERE